

QUAIL PARK MEMORY CARE

RESIDENCES OF WEST SEATTLE



RESIDENCES
of West Seattle

The Only Place to Be!

A FORETHOUGHT FROM CONCEPTION
TO CARE, WE ARE SEATTLE'S BEST
DESIGNATED SECURE MEMORY CARE

(206) 633-2273

QPMCWESTSEATTLE.COM



Purposeful and Dig





Unified Memory Care





Quail
Park
Memo
RESID
of West
The Only T



Tribute Circle

At Quail Park Memory Care Residences of West Seattle it is our profound honor and privilege to share this chapter and the distinct life stories of each resident. We



acknowledge that each person's experience is a complete and imperfect circle. Our Tribute Circle logo was designed by one of our very own residents. The Tribute Program at Quail Park Communities shares a philosophy that a dementia diagnosis doesn't mean the end to all of the meaningful things life has to offer: connection, laughter, adventure and engagement continues with the world around us.

What Sets us Apart?

- Our new state of the art building was **specifically designed for secure and safe memory care**. Our community boasts a warm home-like environment. Each apartment has **temperature controls**, including AC.
- We have **nursing staff** in our community **24 hours a day** allowing us to handle complex issues and reduce hospitalization.
- We offer **Life Engagement programs** that focus on small groups and even one-on-one time.
- We provide innovative programs like **Music Therapy** with Board Certified Music Therapists, Private **Virtual Reality** sessions, **Eldergrow** gardening and **iN2L technology**.
- Our **Signature Dining program** is catered for residents who sleep in or those who are awake at night.

Sample Floor Plans

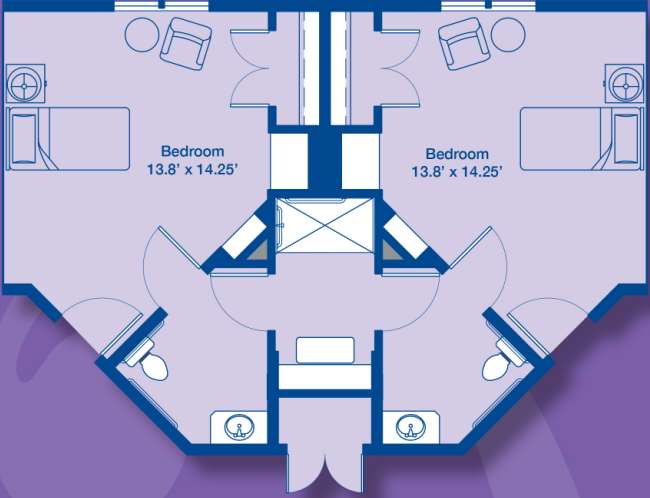

**Tribute Suite
Adjoining Shower**
369 Sq Ft

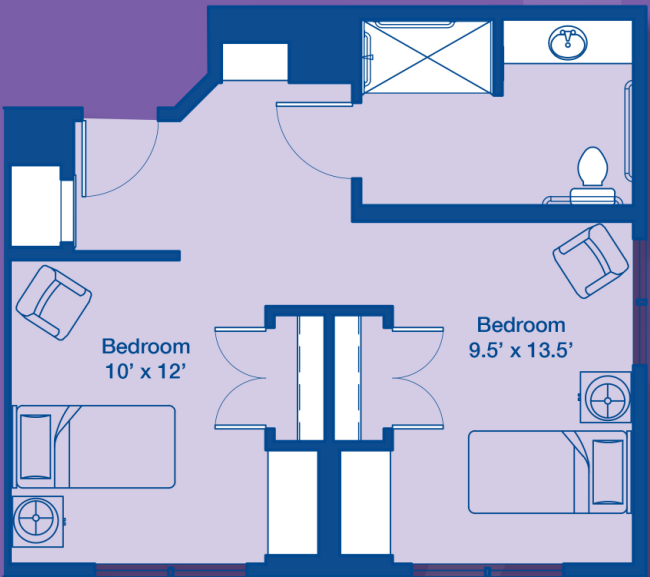

Tribute Shared Suite
517 Sq Ft

*We also have private rooms.
Call for availability and pricing!*

SIMPLY YOUR BEST CHOICE FOR MEMORY CARE!



Quail Park Memory Care Residences of West Seattle

(206) 633-CARE

FIND US ON FACEBOOK!

4515 41st Ave SW • Seattle, WA 98116
qpmcwestseattle.com



Proud Sponsor of the Alzheimer's Association & Members of:

LeadingAge™



West Seattle
Chamber of Commerce

LIVING CARE
Brilliant Senior Living

G S B A
EQUALITY IS GOOD BUSINESS